

## GUIDANCE DOCUMENT: How to login and access the LINEBREAK learning management system.

To access online learning, you will login via the **Rugby Xplorer (RX)** platform.

Most users would have created their RX profiles in 2025. If you **do not** already have a Rugby Xplorer account, **watch this video to see how to sign up and create an RX profile:** [RX – How to sign up](#).

If you already have an account, but cannot remember which email you used, please contact your Provincial Union.

### How to access Rugby Xplorer

To access Rugby Xplorer (if you already have an account):

1. Click on this link: [Rugby Xplorer](#).
2. On the login screen:
  - a. Add the email address you used to create your profile under **"Email"**.
  - b. Add the password you set when you created your profile under **"Password"**.
  - c. Click on the **"Login"** button.

### Login to Continue

New Here? [Create a Rugby Xplorer account](#)

Email \*

Password \*

☐ Remember me for 30 days [Forgot Password](#)

Login

**Note:** We recommend you tick "Remember me for 30 days", this will ensure you stay logged in and have a better experience.

3. A **"Verify Account"** pop up will appear. The system will also send you an email with the verification code.
  - a. Go to your email inbox.
  - b. Open the verification email.
  - c. Add the code into the boxes on the **"Verify Account"** screen.
4. You will then automatically be taken into your profile. Each time you log in, you will always land on your **"My Profile"** page.

### Verify Account

To verify your account, please enter the code sent to your email address or to your mobile.

[Resend Code](#)

Sign In

## How to access the LINEBREAK learning management system

From your Rugby Xplorer profile page:

1. Select **"Learning Portal"** from the left-hand side menu.
2. A pop up will appear with all users associated with your account. Select the user that you would like to access the learning portal by clicking on their name.
3. You will then automatically be taken to your online learning profile and land on your home page.

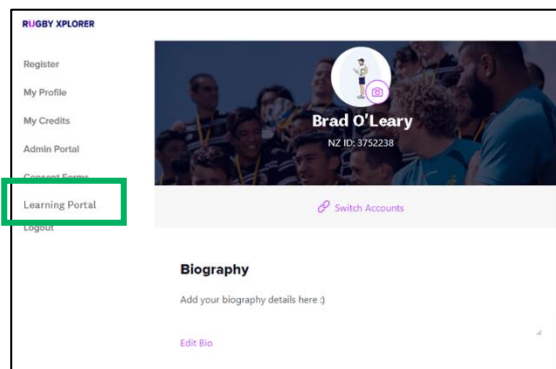

**Note:** An account is automatically created for you as soon as you click the "Learning Portal" heading. Every time you click on this heading again, your details are automatically updated from your Rugby Xplorer account (i.e. if you update your email in RX).

- You **must** use your own account details to ensure your online learning is linked to your official records, avoid technical issues, and receive a certificate (if applicable) in your name.
- The first time you access LINEBREAK, you will need to **accept the Terms and Conditions**.
- If you have any questions, problems or feedback please contact us on [educationhelp@nzrugby.co.nz](mailto:educationhelp@nzrugby.co.nz).

## For "linked accounts"

If you have created secondary accounts (i.e. for your child). For those whose accounts live under yours, you will need to:

1. On your profile, click on the **"Linked Accounts"** link under you NZ ID.
2. The **"Switch Accounts"** pop up will appear. Select the user you would like provide access to learning. This will automatically change the profile you are in.

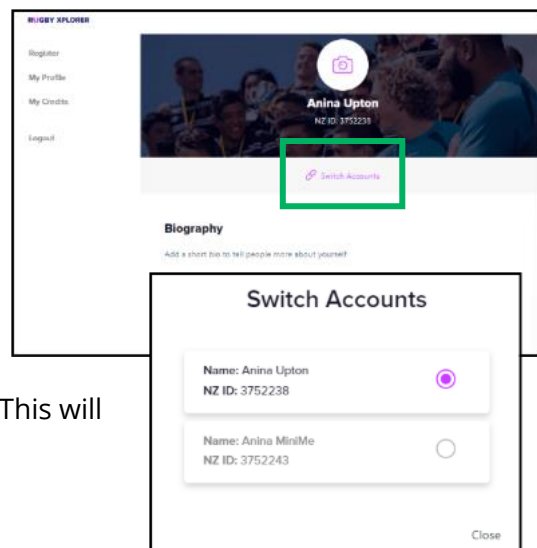

3. Check the top banner, to make sure you are working in the correct profile. You'll note your secondary user has their own NZR ID.
4. Select **"Learning Portal"** from the left-hand side menu.
5. A pop up will appear with all users associated with your account. Select the secondary user that would like to access the learning portal by clicking on their name.

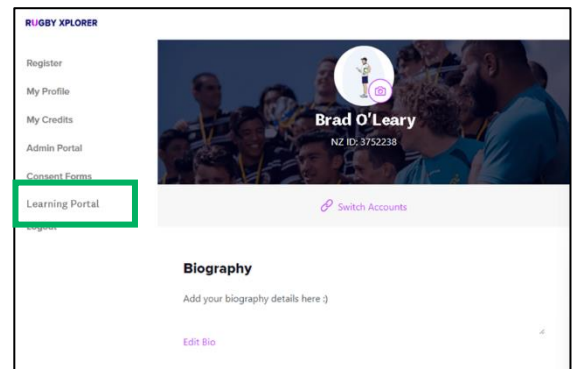

**Note:** For authenticity purposes, the person whose profile is showing must click on the "Learning Portal" button and access their online learning profile. They must complete the learning themselves. The person who created the secondary account is not allowed to complete the training on their behalf.

## How to log out

On the left-hand side of the screen, under your username, you will find the **"Log out"** button. Click this to leave and log back in later via the Rugby Xplorer platform.

